

Sideboard



Design: Marc Spagnuolo
Plans: Marc Spagnuolo & Brian Benham
Version #1

Copyright © 2023 • The Wood Whisperer, Inc. • TheWoodWhisperer.com



TWW[®]



Disclaimer

This project was originally intended to be a Wood Whisperer Guild course. Because the design became quite complex with lots of impromptu changes, it became difficult to track all of the details and that's why we opted to release this course for free. As a result, these plans may not be perfect. If you see a glaring issue, let us know. These plans are provided with no warranty and you should double check everything before making cuts if you actually intend to build this piece.

Thank you,
TWW Team

Cut List

Designation	QTY	Material	Thickness	Width	Length
A - Leg	4	8/4 Walnut	1 3/4"	1 3/4"	35"
B - Side Rail	4	4/4 Walnut	3/4"	2 1/2"	17 1/4"
C - Side Panel	2	4/4 Walnut	1/2"	17 3/4"	18 1/2"
D - Front web Frame Rail	2	4/4 Walnut	3/4"	4 1/4"	54 1/8"
E - Rear Web Frame Rail	2	4/4 Walnut	3/4"	2"	54 1/8"
F - Web Frame Stile Side	4	4/4 Walnut	3/4"	2"	14 1/2"
G - Web Frame Stile Lower Center	4	4/4 Walnut	3/4"	3 1/2"	14 1/2"
H - Web Frame In Set Panel	2	4/4 Walnut	1/2"	14 9/16"	15"
I - Center Divider Panel	2	1/2" Plywood	1/2"	15 1/4"	18 1/2"
J - Center Divider Rail	4	4/4 Walnut	3/4"	2"	15 1/4"
K - Center Stile Front	2	4/4 Walnut	3/4"	2"	22"
K - Center Stile Rear	2	4/4 Walnut	3/4"	2"	22"
L - Back Support	1	4/4 Walnut	3/4"	3 1/2"	54 1/8"
N - Door Assembly	1	4/4 Walnut	3/4"	18"	21 13/16"
O - Top	1	5/4 Walnut	1"	21 3/4"	59 5/8"
P - Drawer Bottom	4	1/4" Plywood	1/4"	15 5/16"	17 1/2"
Q - Drawer Sides	8	4/4 Alder	1/2"	4 9/16"	18"
R - Drawer Front/Back	8	4/4 Alder	1/2"	4 9/16"	15 13/16"
S - Drawer Pull	4	4/4 Walnut	3/4"	1 3/4"	17 15/16"
T - Drawer Face	4	4/4 Walnut	1/2"	3 9/16"	17 15/16"
U - Self Ladder	8	4/4 Walnut	3/4"	2"	21 1/2"
V - Shelf Support	4	4/4 Walnut	3/4"	1"	17 3/16"
W - Shelf	2	4/4 Walnut	3/4"	17 15/16"	19 1/8"

Note: In lieu of veneering panels, you can use 1/2" plywood as shown in the cut list.

Material List

- 5BF - 8/4 Walnut
- 15BF - 5/4 Walnut
- 36BF - 4/4 Walnut
- 15BF - 4/4 Cherry or Alder (secondary wood)
- 1 Sheet - 1/4" Plywood
- 1 Sheet - 1/2" Plywood
- 4 Ea - 18" Blum Tandem Drawer Glides
- Some copper and slab veneers if you want to get fancy

Note: All board foot listings have had 20% waste added and rounded up to the nearest foot

Elevations

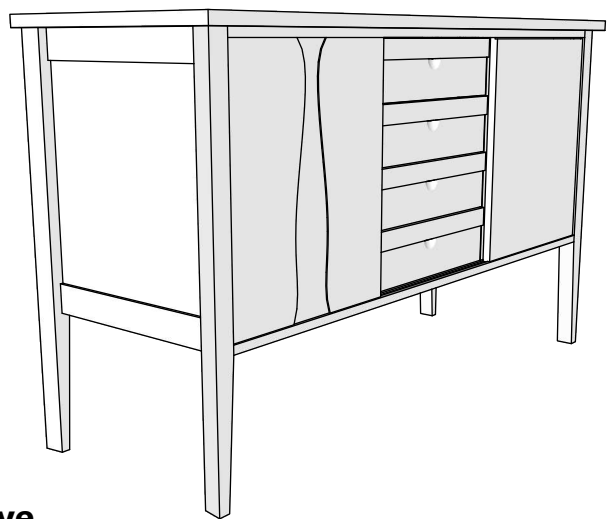

Perspective

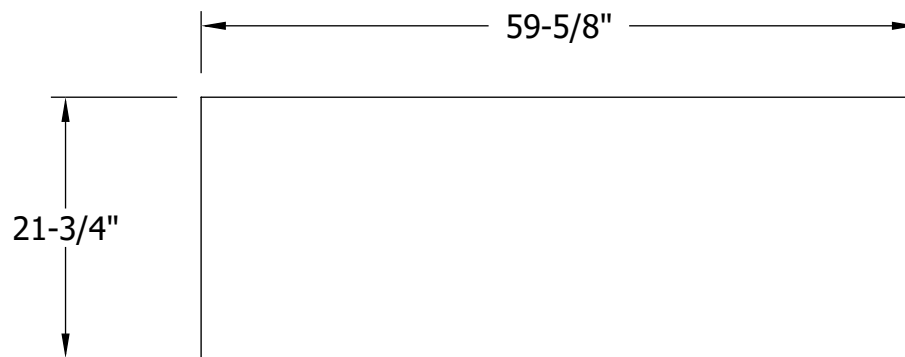

Top View

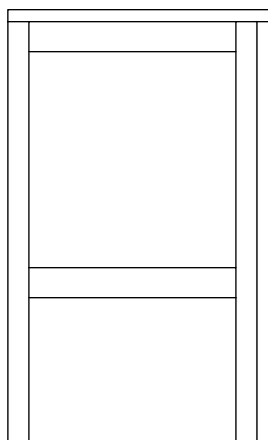

Left View

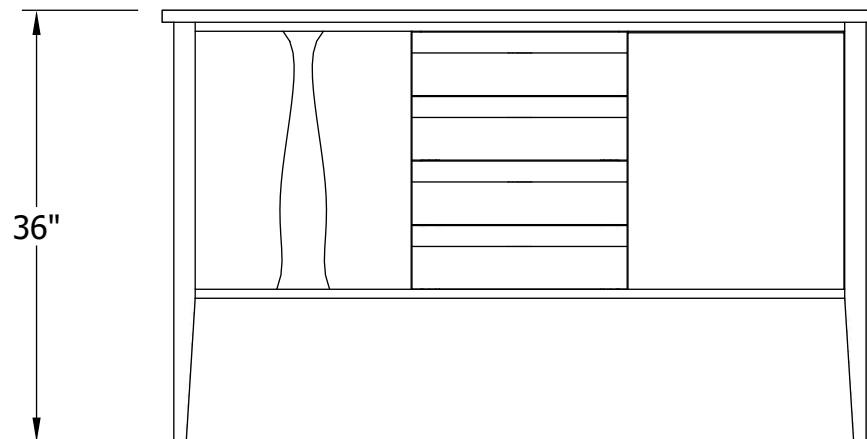

Front View

Exploded View

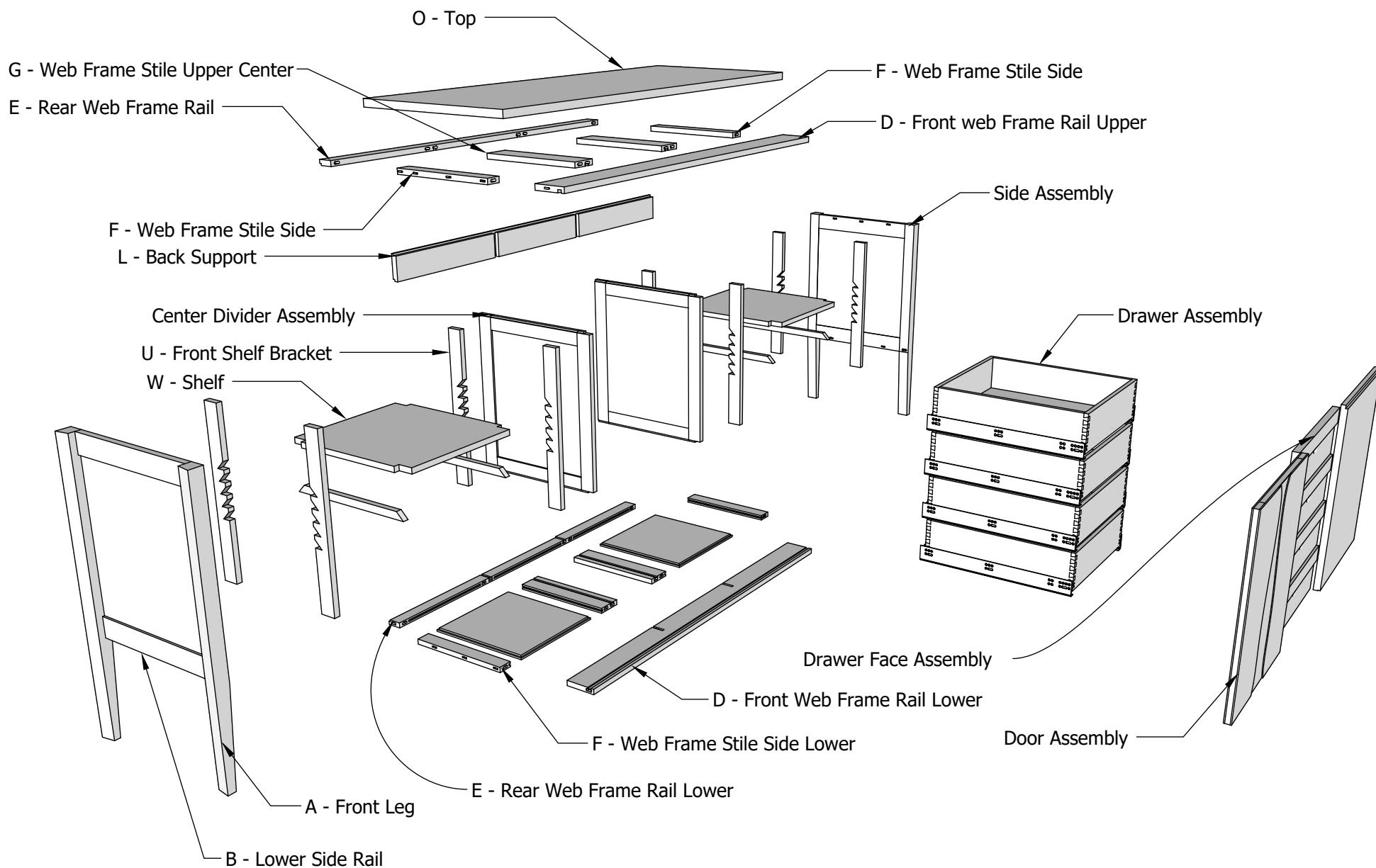

Leg Detail

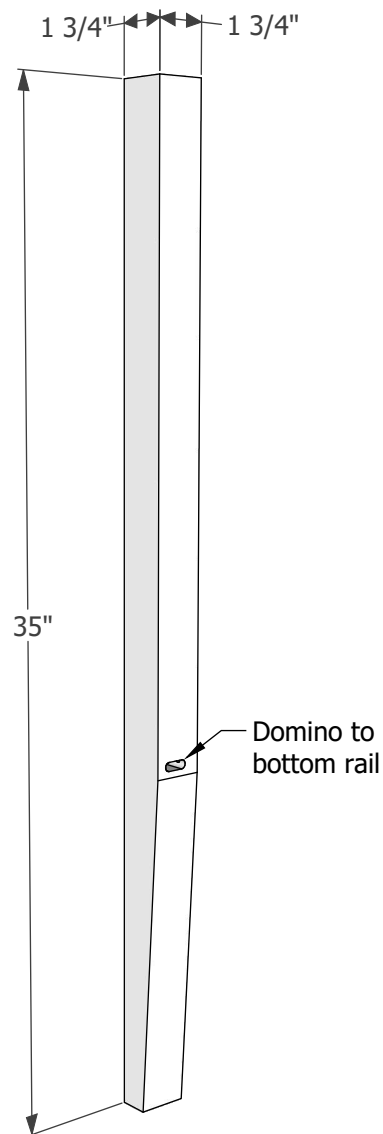

Perspective
Left Front Leg Shown

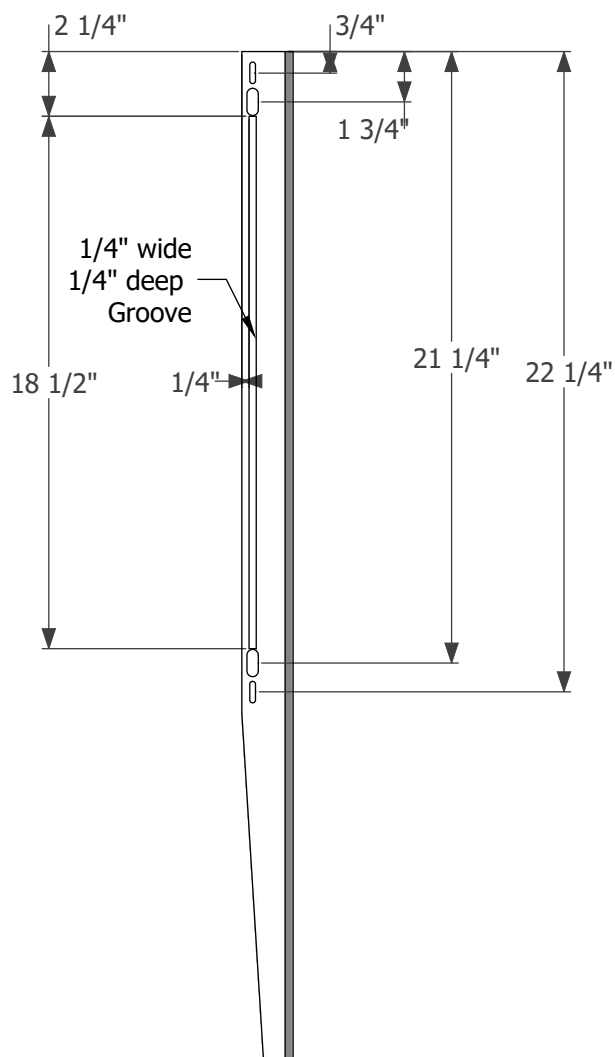

Faces Side Panel
Left Front Leg Shown

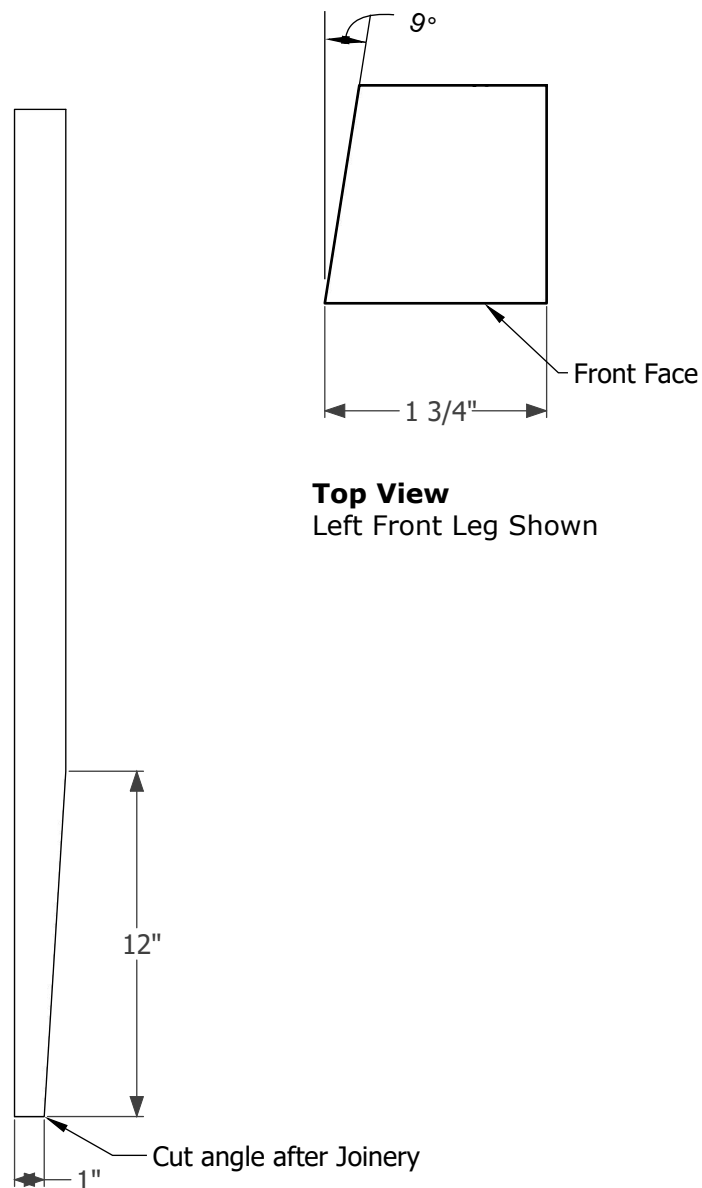

Front Face
Left Front Leg Shown

Top View
Left Front Leg Shown

Side Detail

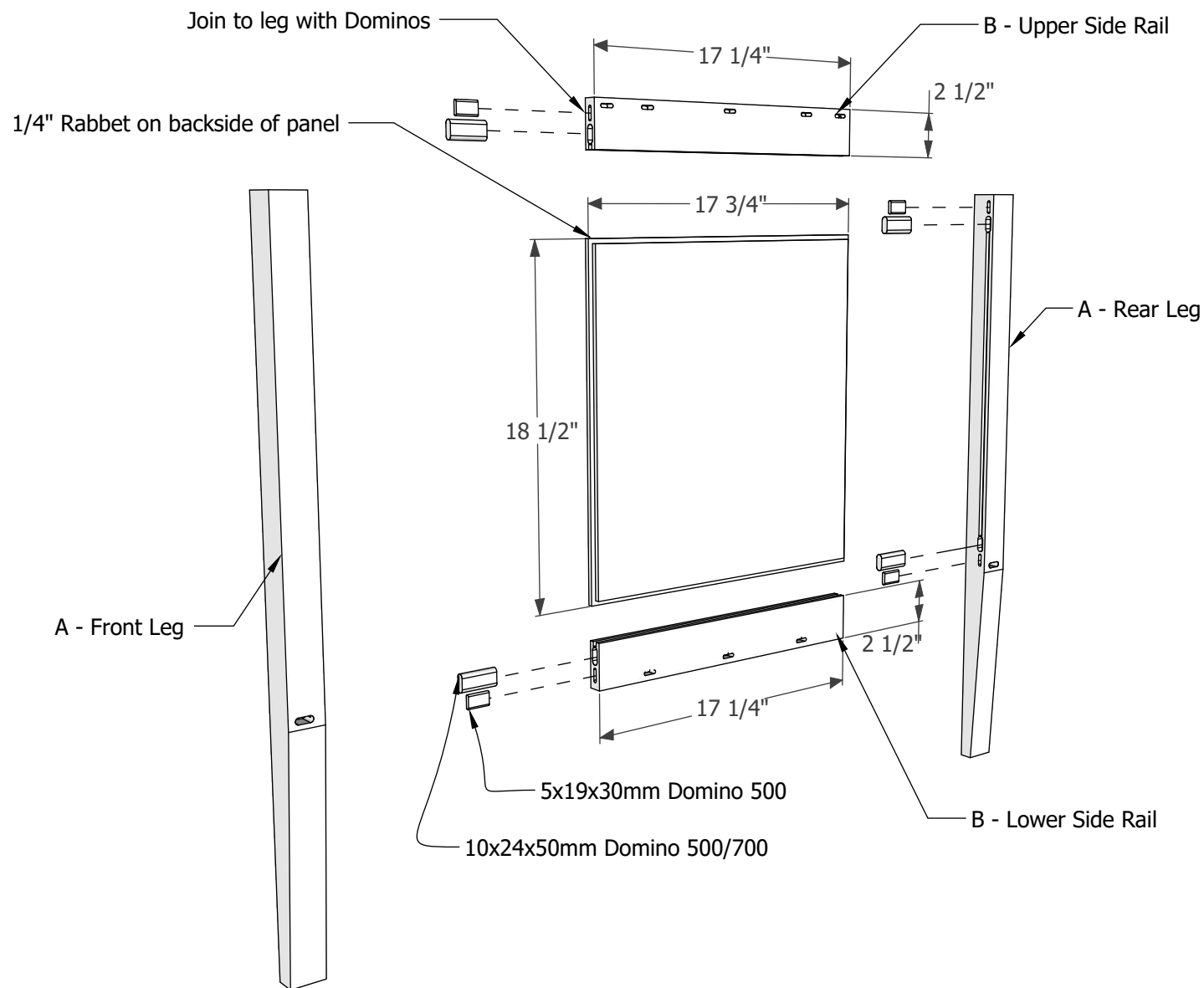

Top Web Frame

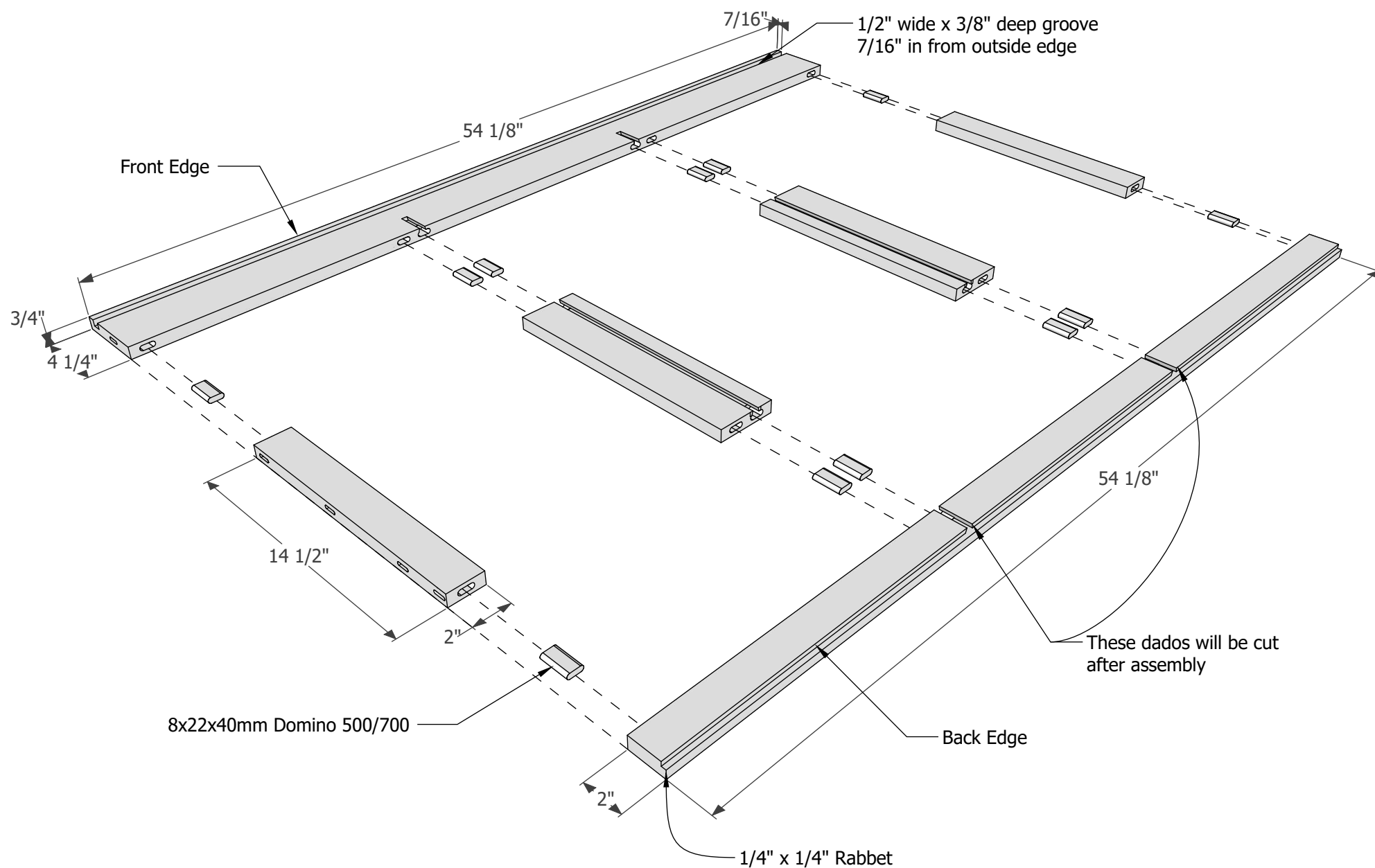

Web Frame Bottom

Note: Bottom Web Frame is a mirror of the top web frame with the exception of the plywood inserts and groove along front edge.

See next page for plywood insert detail

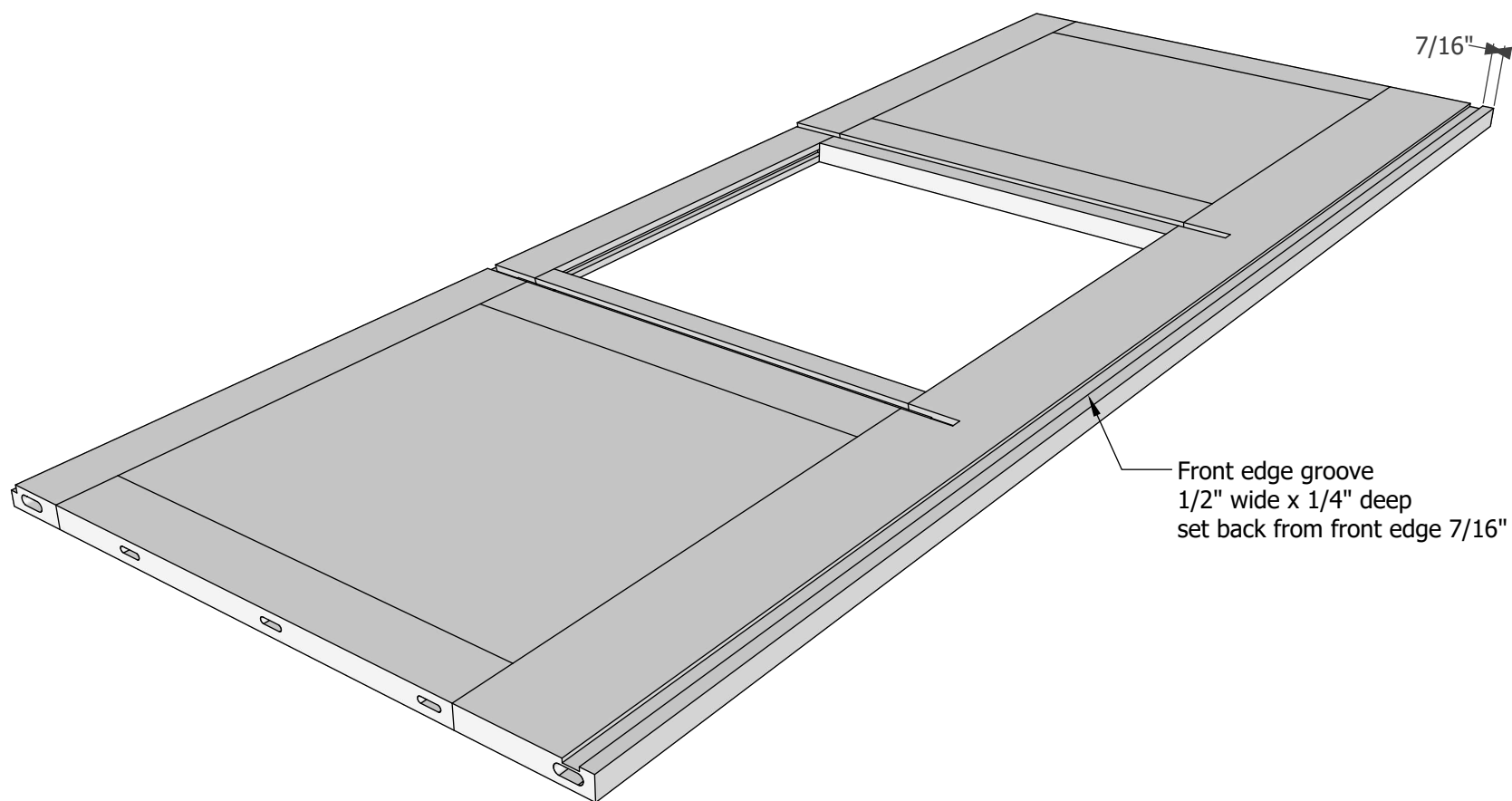

Plywood Inserts

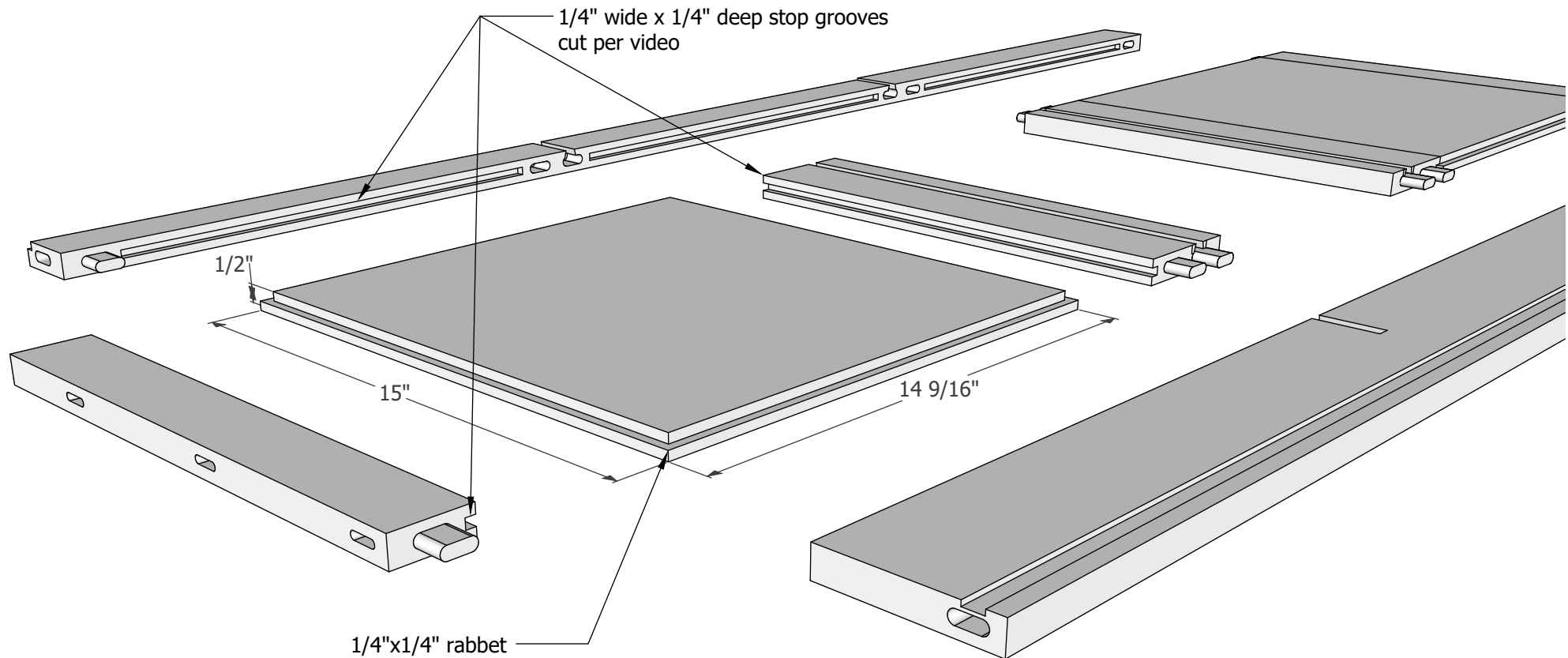



TWW[®]

Side Assembly Domino Location

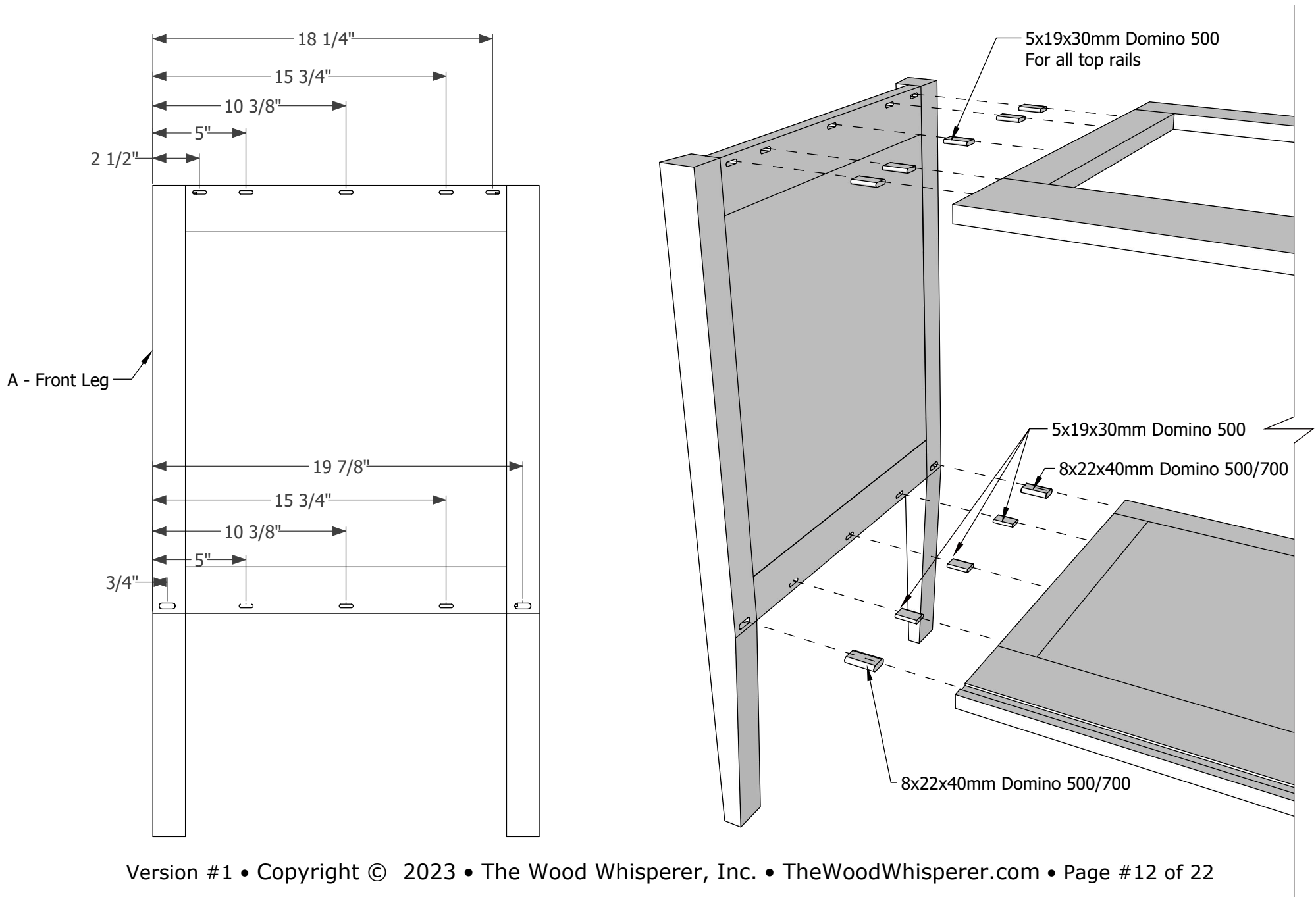

Center Divider Panels

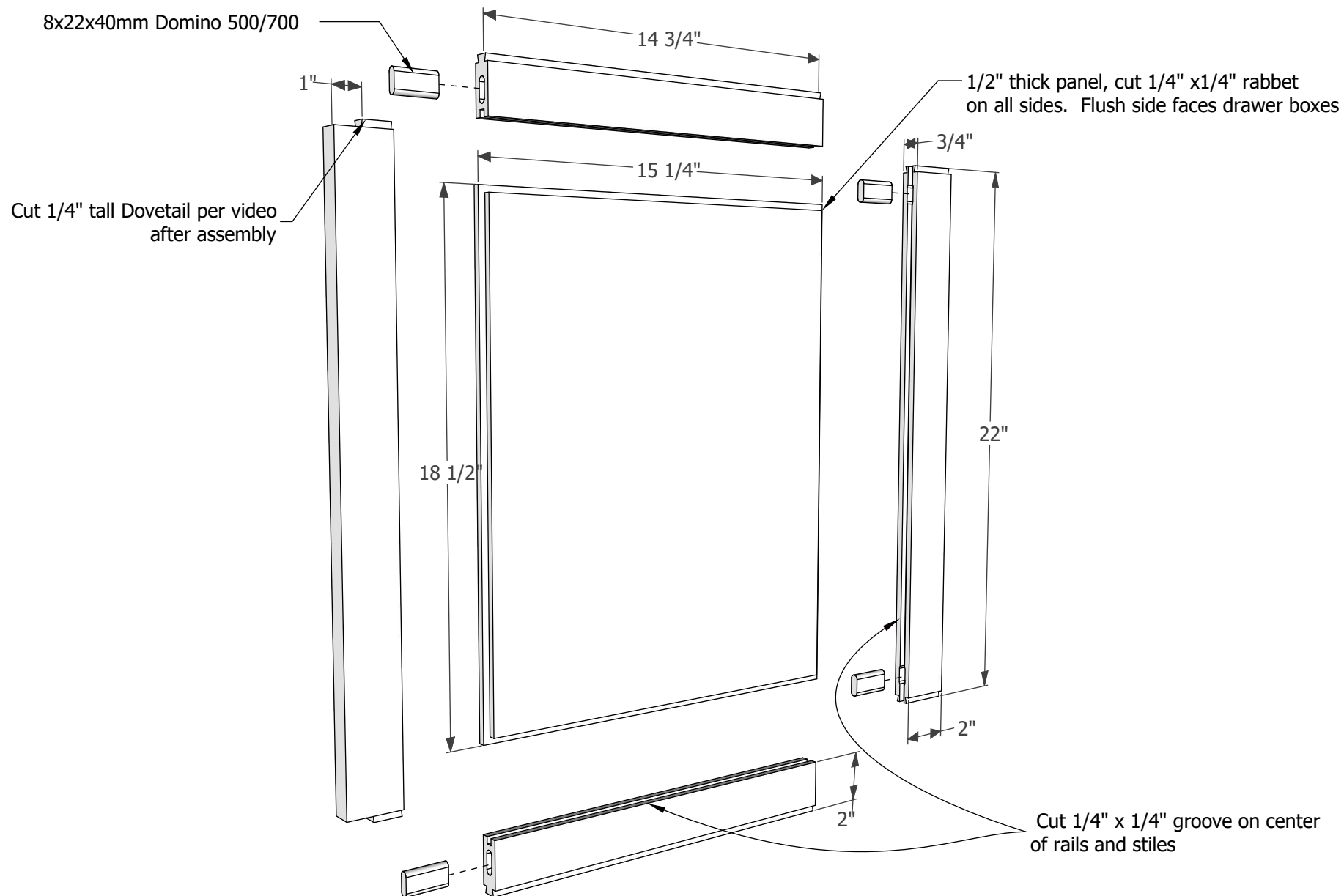

Dovetail Web Frame

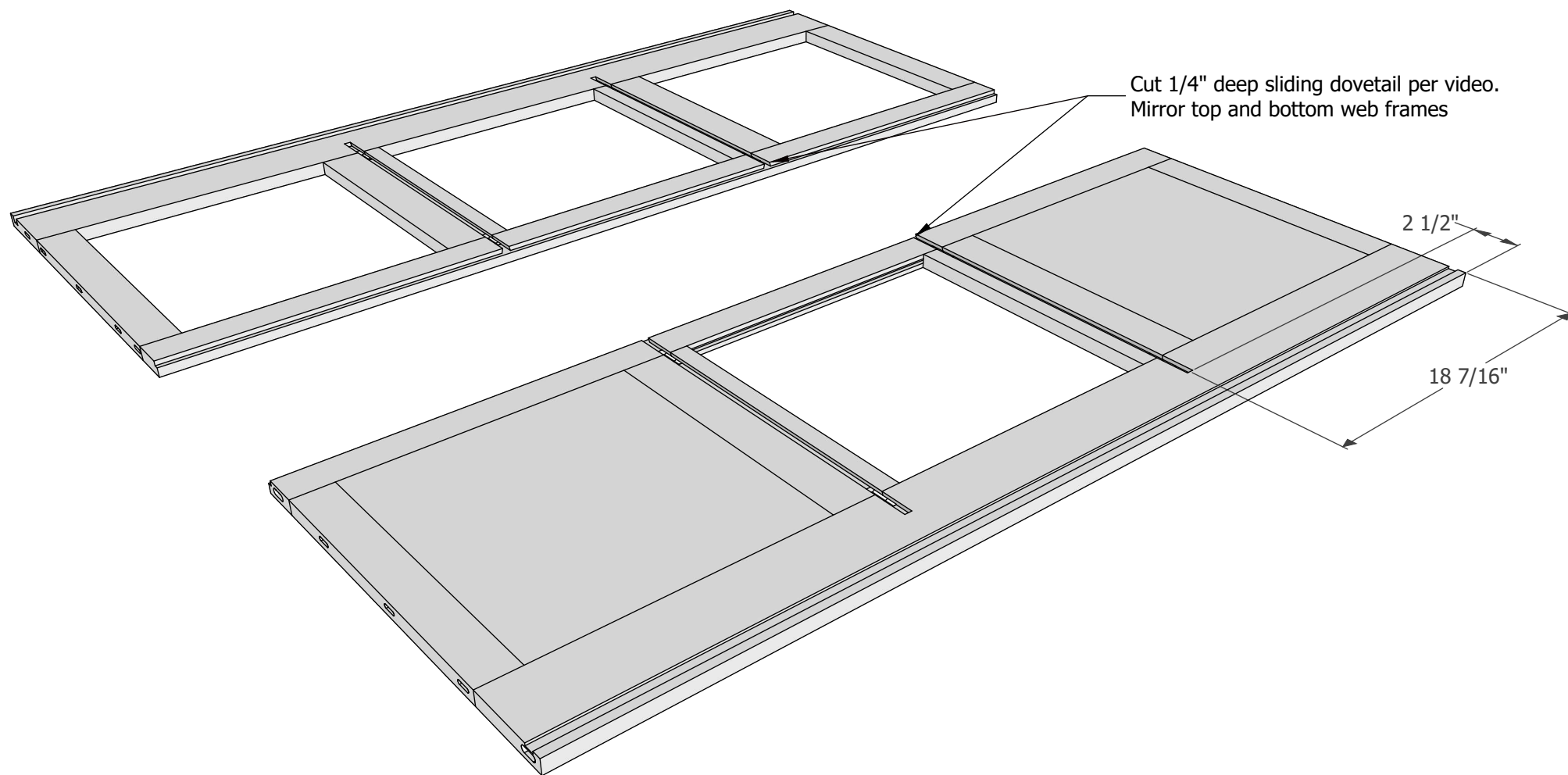

Back Brace

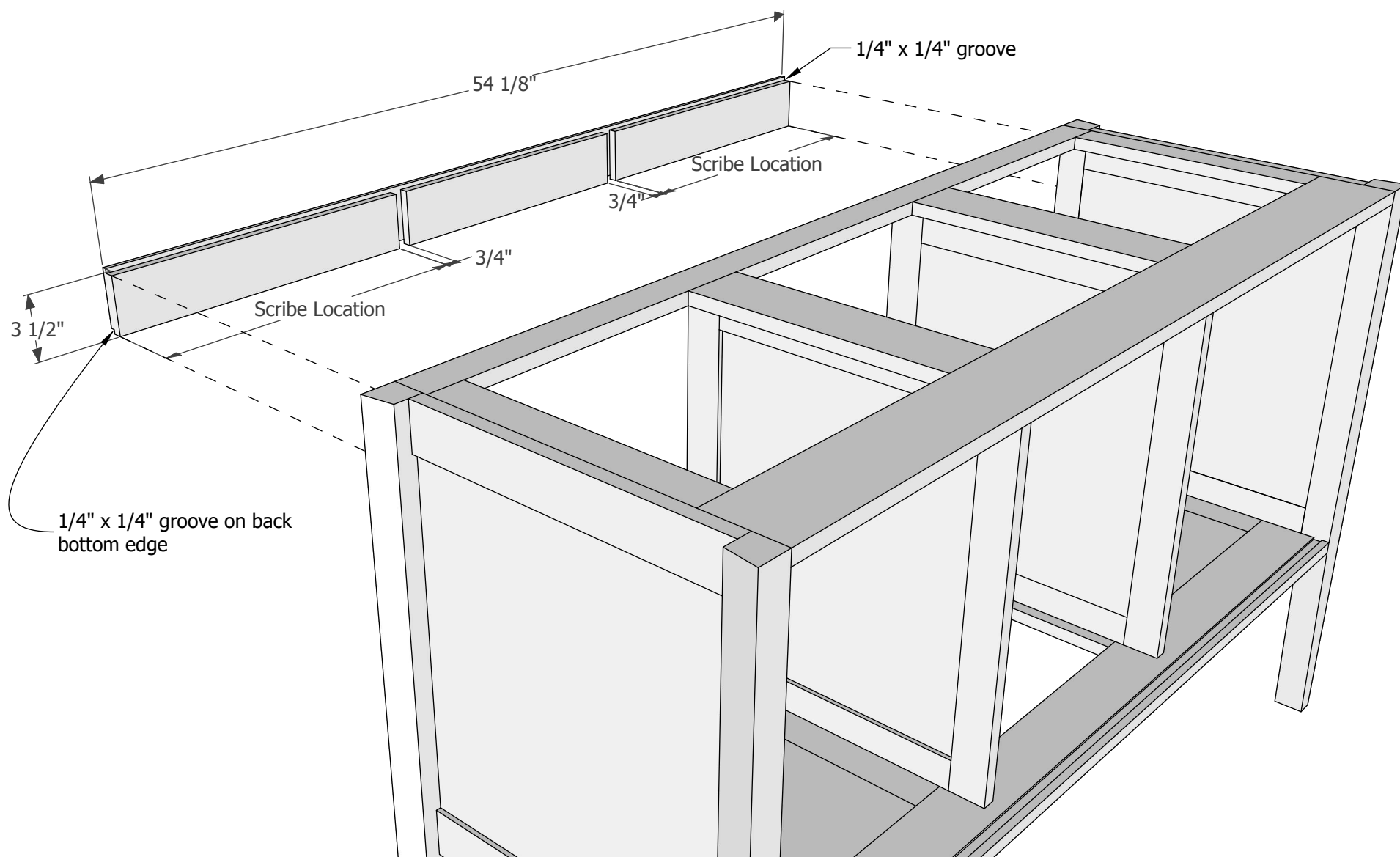

Door Detail

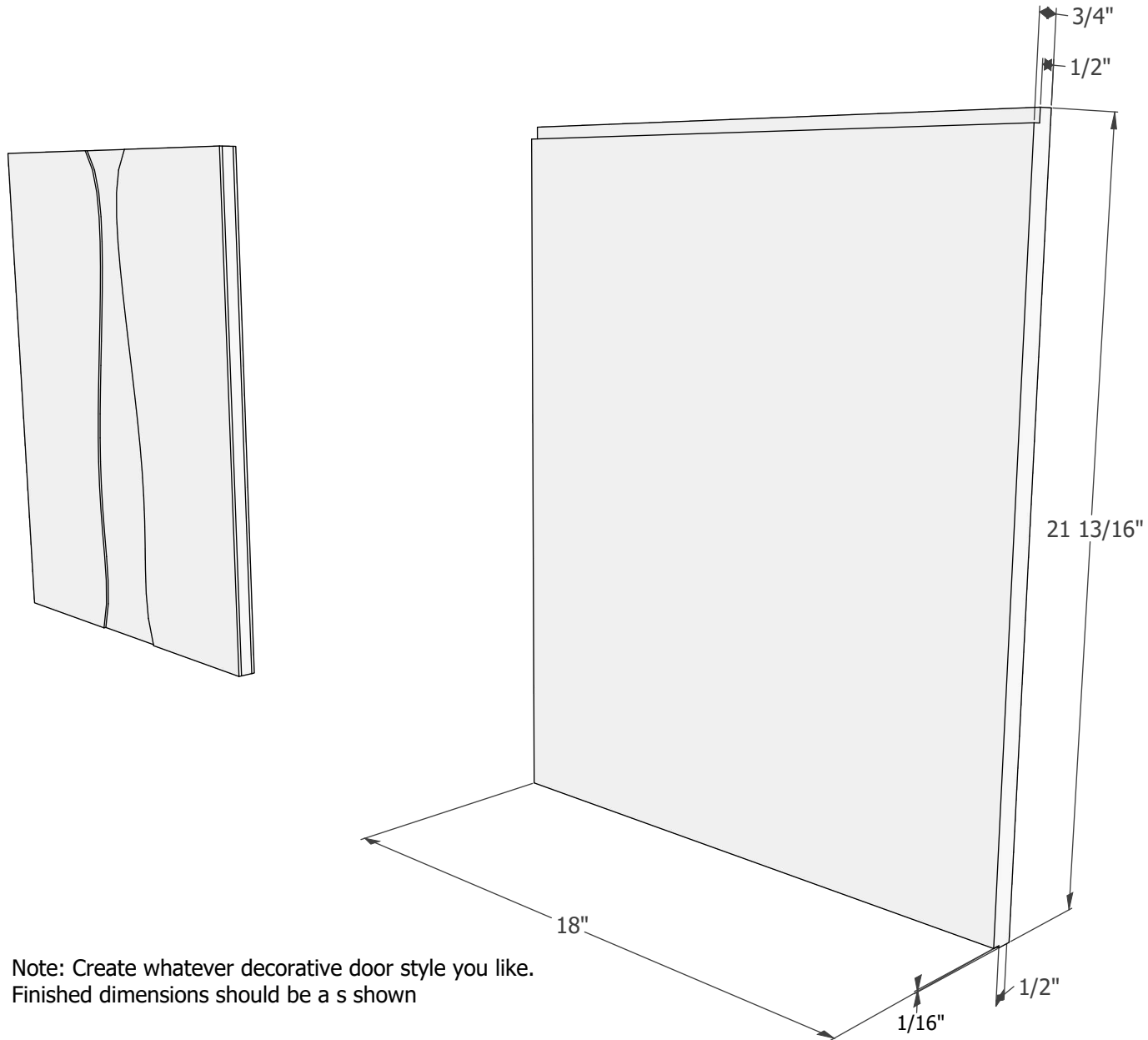

Drawer Detail

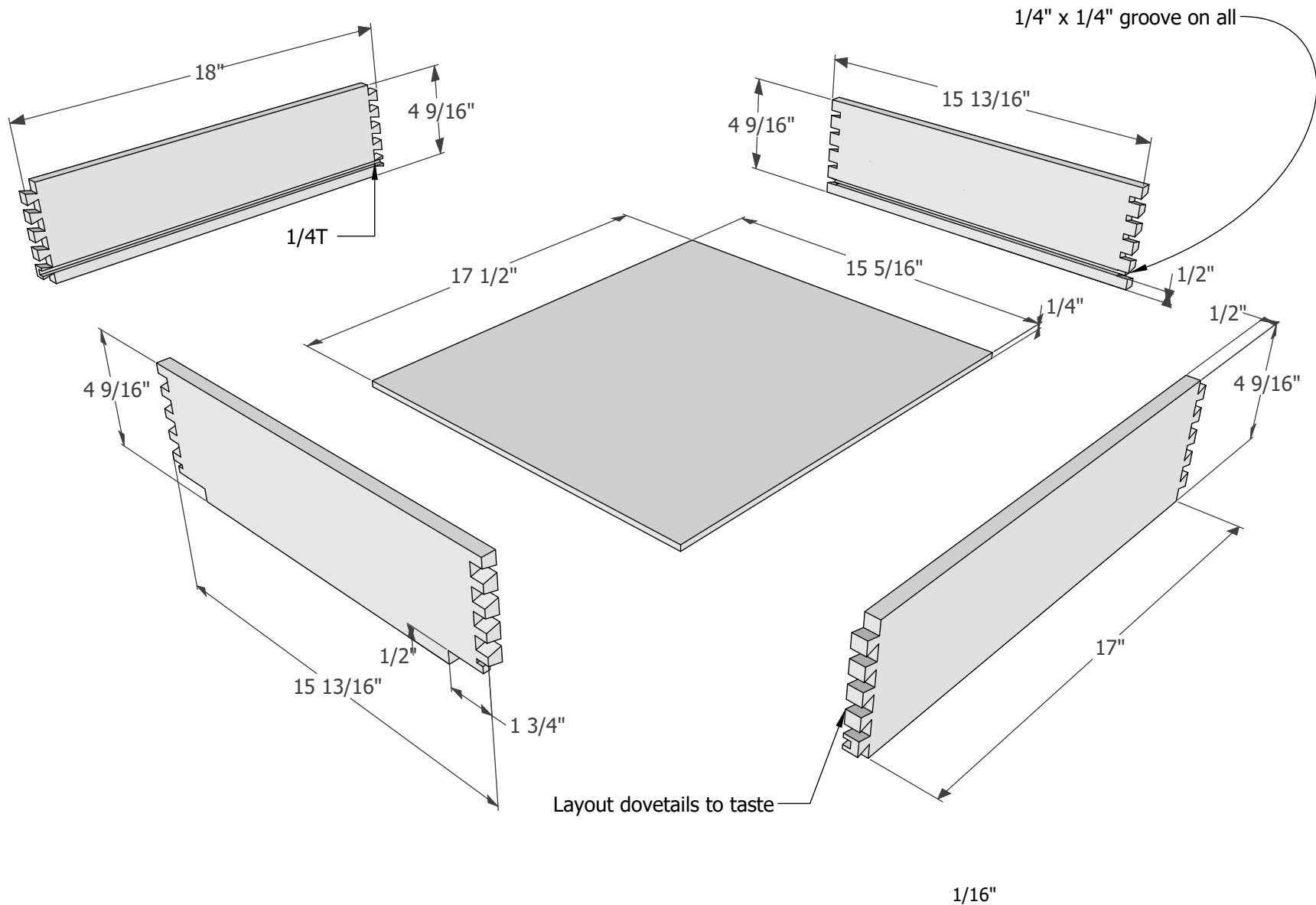

Drawer Glide Install

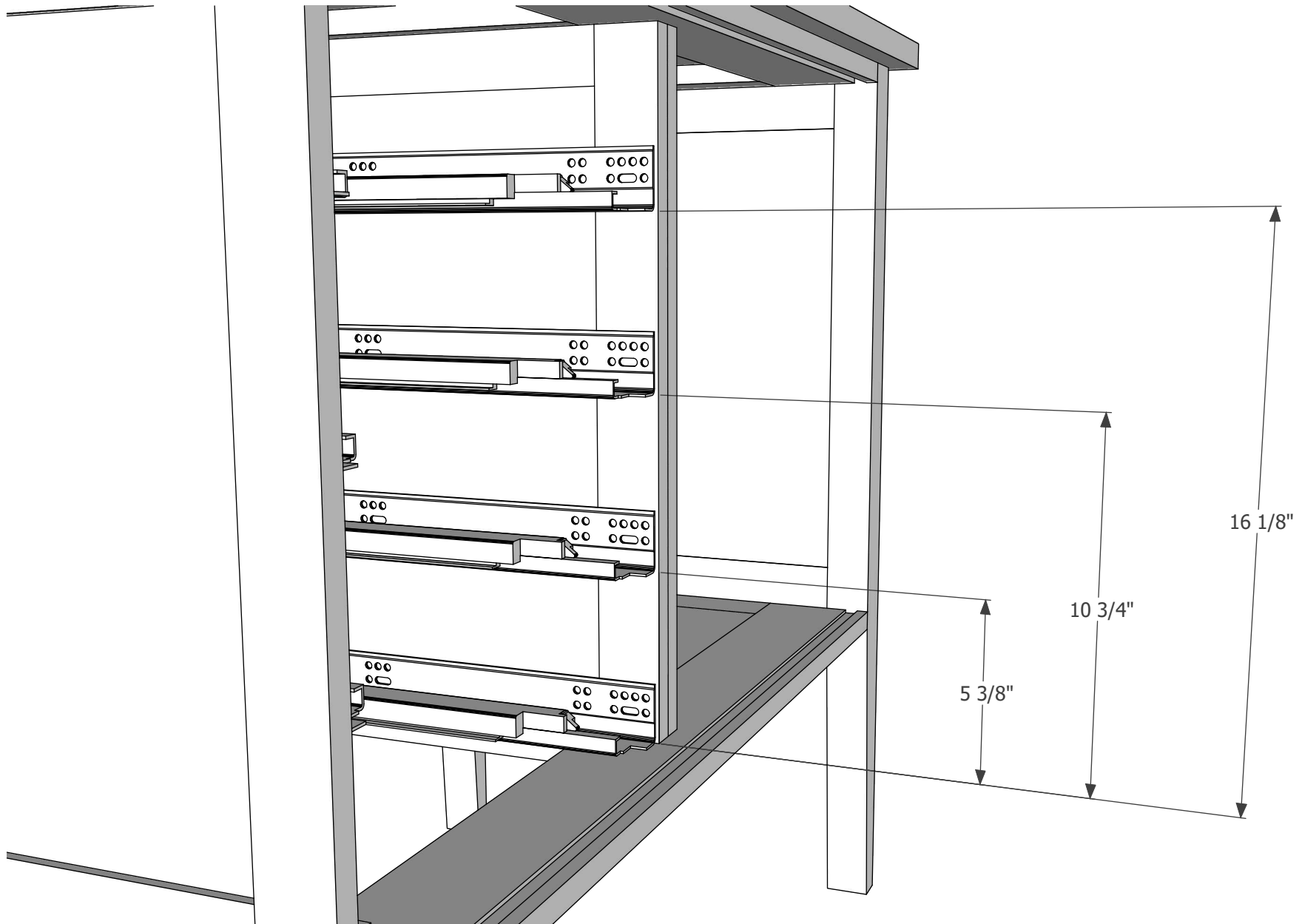

Drawer Fronts

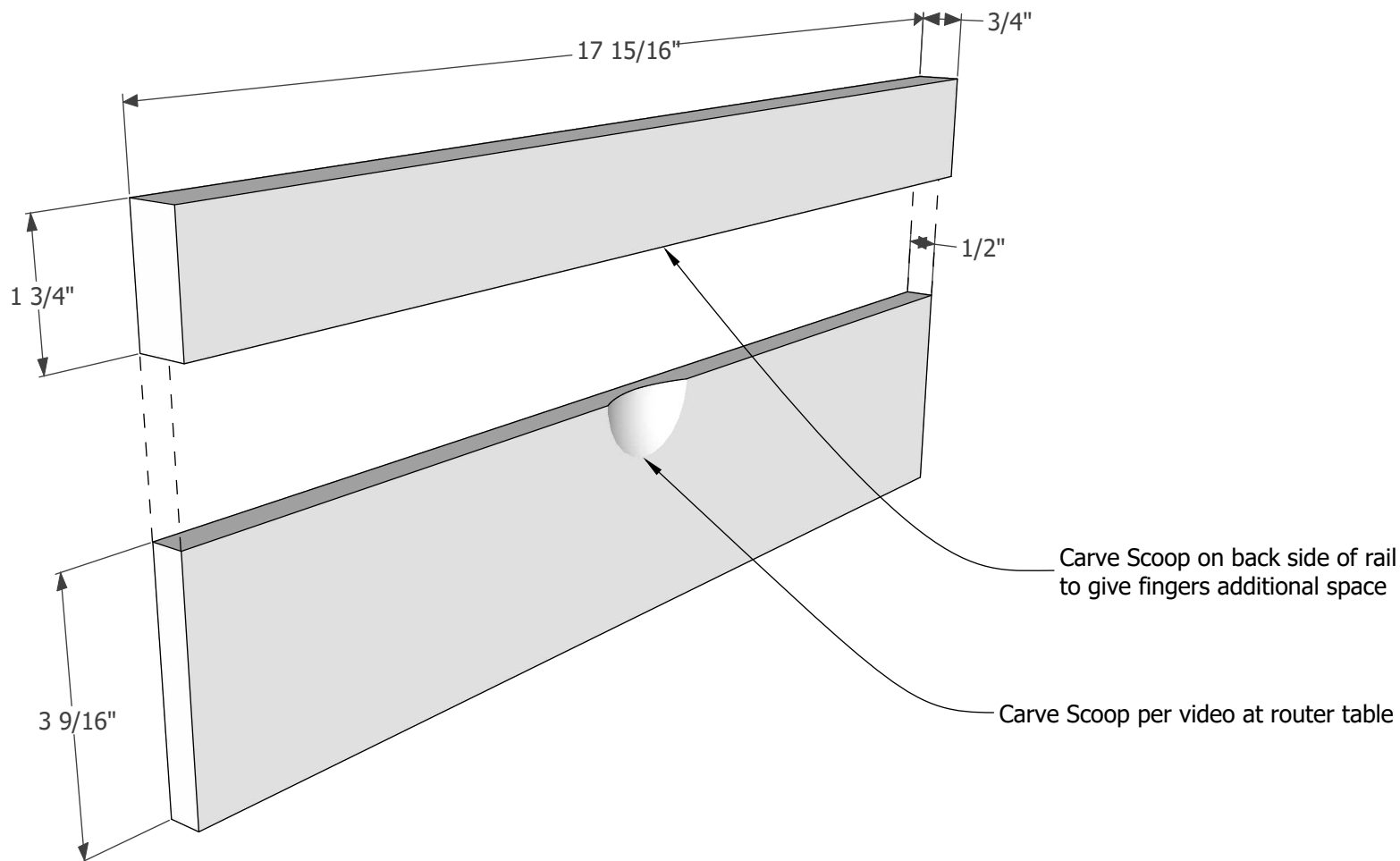

Shelf Ladder

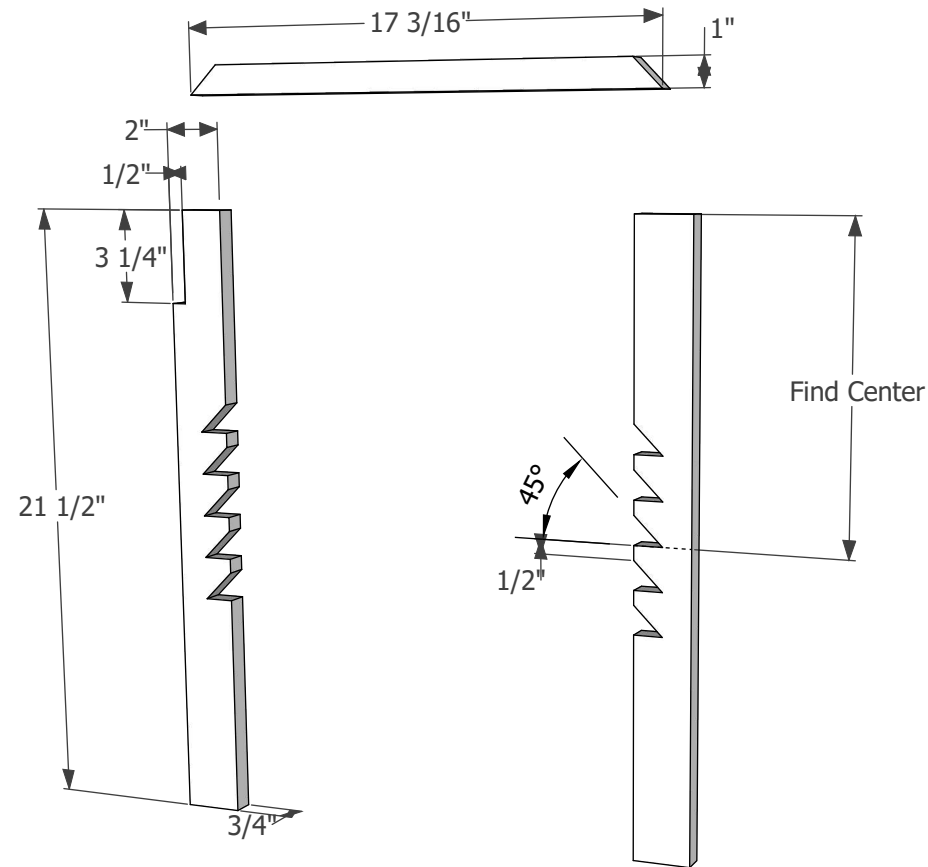

Shelf Ladder Setback

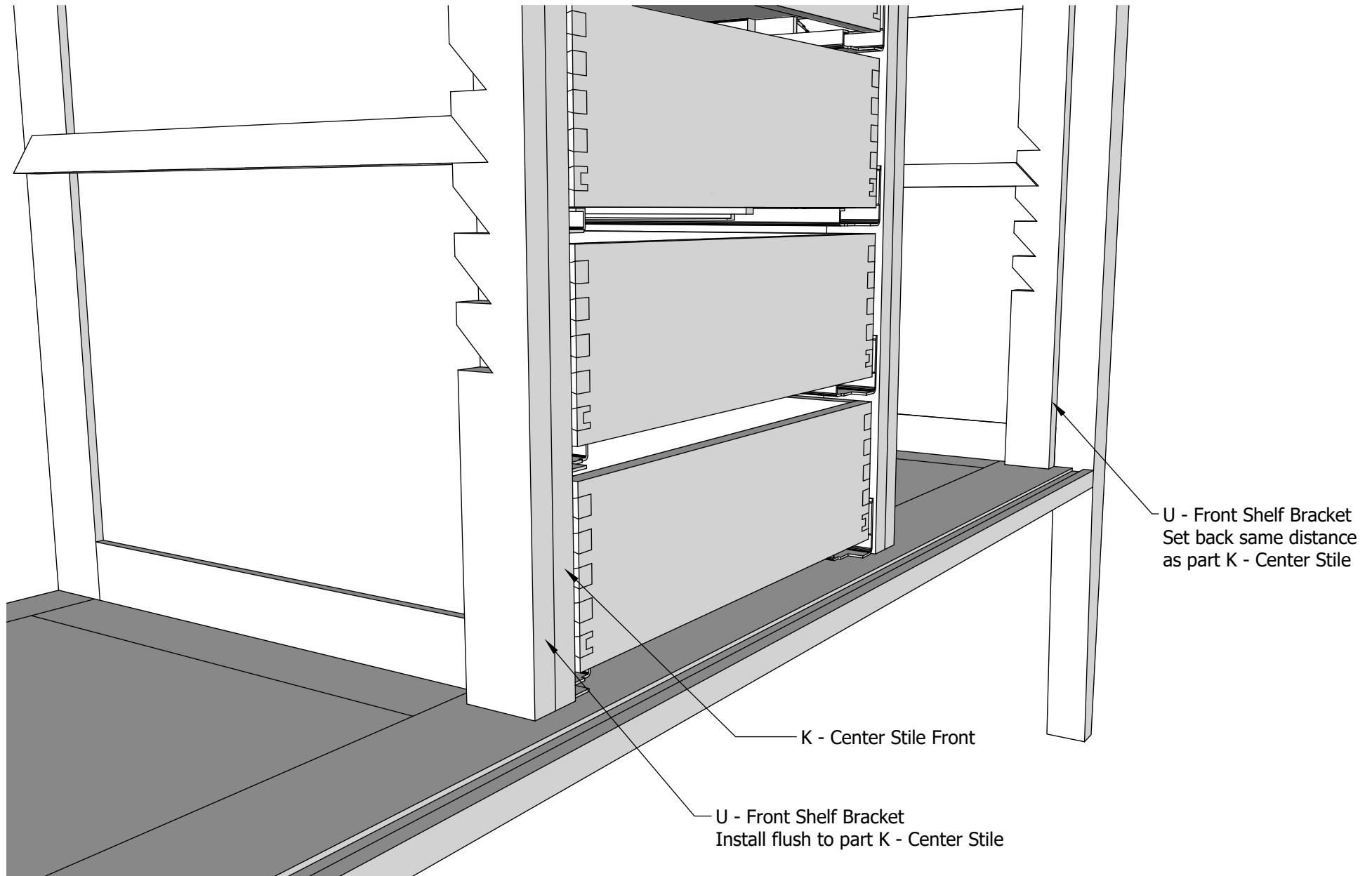

Shelf

